

J:\Canby\1009\1009 INDUSTRIAL PARK UTILITIES.dwg, 2/27/2018 7:40:16 AM, DWG To PDF.pc3

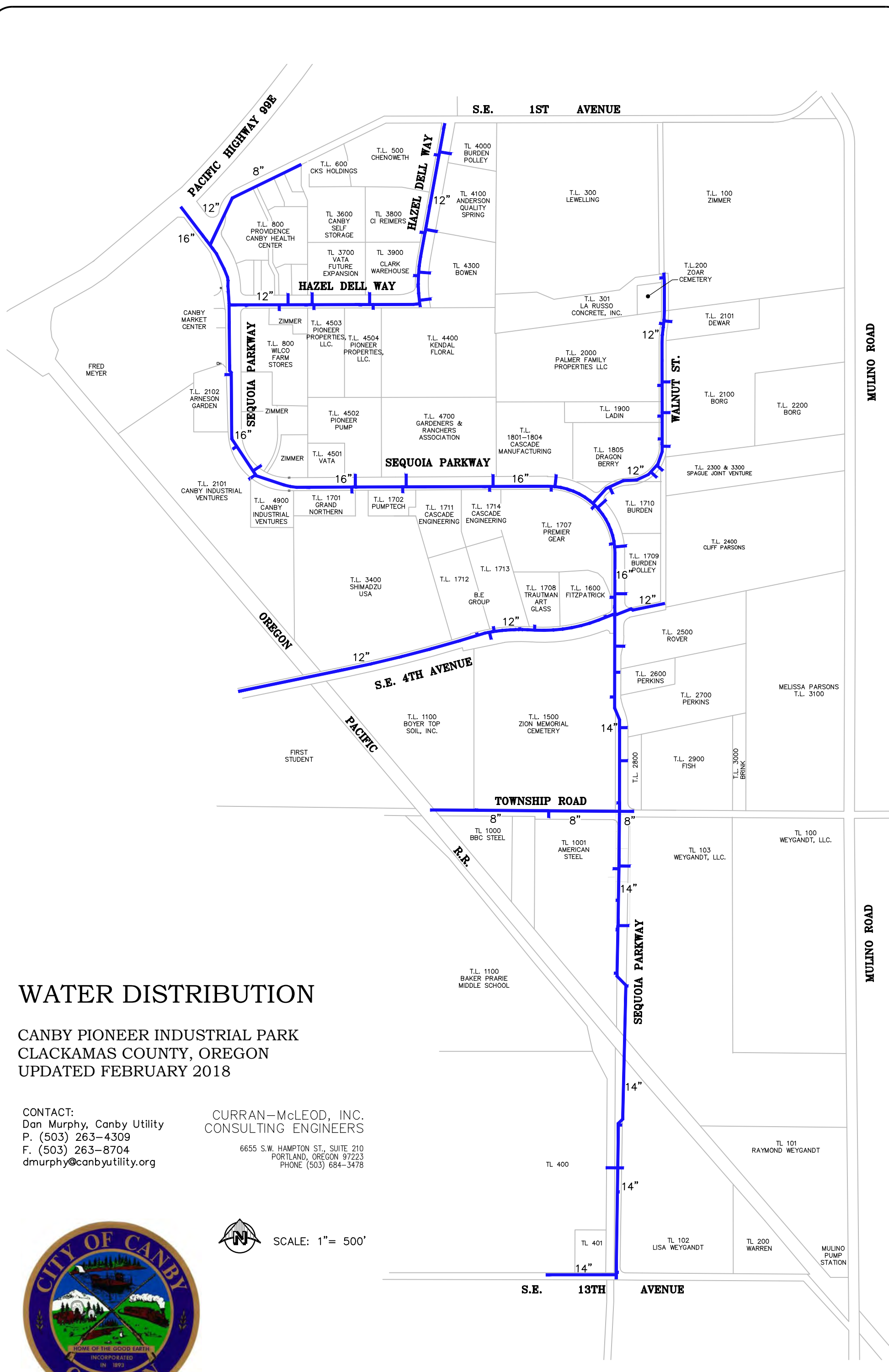

WATER DISTRIBUTION

CANBY PIONEER INDUSTRIAL PARK
 CLACKAMAS COUNTY, OREGON
 UPDATED FEBRUARY 2018

CONTACT:
 Dan Murphy, Canby Utility
 P. (503) 263-4309
 F. (503) 263-8704
 dmurphy@canbyutility.org

CURRAN-McLEOD, INC.
 CONSULTING ENGINEERS
 6655 S.W. HAMPTON ST., SUITE 210
 PORTLAND, OREGON 97223
 PHONE (503) 684-3478



THIS MAP SHOULD NOT BE USED FOR SURVEY OR ENGINEERING PURPOSES. THE CITY IS NOT RESPONSIBLE FOR MAP ERRORS, OMISSIONS, MISUSE OR MISINTERPRETATIONS.